

**RESOLUTION NO. 2019- \_\_\_\_\_**

**A RESOLUTION ACCEPTING ADDENDUM NO. 7 IN AN AMOUNT NOT TO EXCEED \$1,403,491 SUBMITTED BY SKANSKA USA BUILDING, INC. TO THE GUARANTEED MAXIMUM PRICE PROPOSAL DATED APRIL 3, 2018 FOR CONSTRUCTION OF THE CITY INFRASTRUCTURE REQUIRED TO SUPPORT, INSTALL AND ILLUMINATE JANET ECHELMAN INC. (JEI) NET SCULPTURE; APPROVING A TRANSFER IN THE AMOUNT OF \$1,000,000 FROM THE UNAPPROPRIATED BALANCE OF THE DOWNTOWN REDEVELOPMENT DISTRICT FUND (1105) TO THE GENERAL CAPITAL IMPROVEMENT FUND (3001) TO PROVIDE FUNDING FOR THE CONSTRUCTION OF THE CITY'S INFRASTRUCTURE FOR THE JEI NET SCULPTURE; APPROVING A SUPPLEMENTAL APPROPRIATION IN THE AMOUNT OF \$1,000,000 FROM THE INCREASE IN THE UNAPPROPRIATED BALANCE OF THE GENERAL CAPITAL IMPROVEMENT FUND (3001), RESULTING FROM THE ABOVE TRANSFER, TO THE PIER APPROACH PROJECT (15377); APPROVING A TRANSFER IN THE AMOUNT OF \$400,000 FROM THE UNAPPROPRIATED BALANCE OF THE PIER ECHELMAN SCULPTURE DONATION FUND (1889) RESULTING FROM DONATIONS FROM PRIVATE PERSONS AND ENTITIES TO FUND THE ARTWORK (INCLUDING INFRASTRUCTURE NEEDED TO SUPPORT ARTWORK) TO THE GENERAL CAPITAL IMPROVEMENT FUND (3001); APPROVING A SUPPLEMENTAL APPROPRIATION IN THE AMOUNT OF \$400,000 FROM THE INCREASE IN THE UNAPPROPRIATED BALANCE OF THE GENERAL CAPITAL IMPROVEMENT FUND (3001) RESULTING FROM THE ABOVE TRANSFER TO THE PIER APPROACH PROJECT (15377); AND PROVIDING AN EFFECTIVE DATE.**

**WHEREAS**, the City of St. Petersburg, Florida ("City") and Skanska USA Building, Inc. ("Skanska") entered into a Construction Manager at Risk Agreement with a Guaranteed Maximum Price ("GMP") on January 10, 2017, for Skanska to provide preconstruction and construction phase services for the Pier Approach Project; and

**WHEREAS**, on April 19, 2018, the City and Skanska executed the First Amendment to (i) incorporate the GMP Proposal in an amount not to exceed \$15,030,610 dated April 3, 2018, into the agreement, (ii) add additional preconstruction phase services, (iii) revise the disadvantaged worker and apprentices provision to clarify good faith efforts and retainer, and (iv) modify other necessary provisions; and

**WHEREAS**, on June 14, 2018, the City and Skanska executed the Second Amendment to increase the GMP by an additional \$185,239 for pile procurement for the Doc Ford's Restaurant; and

**WHEREAS**, on July 19, 2018, the City and Skanska executed the Third Amendment to increase the GMP by an additional \$581,611 for installation of the piles procured for the Doc Ford's Restaurant; and

**WHEREAS**, on August 2, 2018, the City and Skanska executed the Fourth Amendment for Skanska to provide additional preconstruction phase services related to the Janet Echelman net sculpture for an amount not to exceed \$20,000; and

**WHEREAS**, on September 7, 2018, the City and Skanska executed the Fifth Amendment to increase the GMP by an additional \$1,085,737 for the installation of the structural system for the Doc Ford's Restaurant and to revise the project schedule; and

**WHEREAS**, on October 4, 2018, the City and Skanska executed the Sixth Amendment to increase the GMP by an additional \$2,964,769 for the construction of the new North Yacht Basin Seawall adjacent to the New St. Pete Pier™; and

**WHEREAS**, on January 3, 2019, the City and Skanska executed the Seventh Amendment to increase the GMP by an additional \$1,835,532 for completion of the construction of the Doc Ford's Full Core & Shell and to revise the project schedule; and

**WHEREAS**, in accordance with the agreement, as amended, Skanska has submitted Addendum No. 7 in an amount not to exceed \$1,403,491 for construction of the City infrastructure required to support, install and illuminate Janet Echelman Inc. (JEI) net sculpture to the City for acceptance.

**NOW THEREFORE BE IT RESOLVED** by the City Council of the City of St. Petersburg, Florida, that Addendum No. 7 in an amount not to exceed \$1,403,491 submitted by Skanska USA Building, Inc. to the Guaranteed Maximum Price proposal dated April 3, 2018 for construction of the City infrastructure required to support, install and illuminate Janet Echelman Inc. (JEI) net sculpture is hereby accepted.

**BE IT FURTHER RESOLVED** that there is hereby approved the following transfer for FY19:

<u>Downtown Redevelopment District Fund (1105)</u>	
General Capital Improvement Fund (3001)	\$1,000,000

**BE IT FURTHER RESOLVED** that there is hereby approved from the increase in the unappropriated balance of the General Capital Improvement Fund (3001), resulting from the above transfer, the following supplemental appropriation for FY19:

<u>General Capital Improvement Fund (3001)</u>	
Pier Approach Project (15377)	\$1,000,000

**BE IT FURTHER RESOLVED** that there is hereby approved the following transfer for FY 2019:

<u>Pier Echelman Sculpture Donation Fund (1889)</u>	
General Capital Improvement Fund (3001)	\$400,000

**BE IT FURTHER RESOLVED** that there is hereby approved from the increase in the unappropriated balance of the General Capital Improvement Fund (3001) resulting from the above transfer, the following supplemental appropriation for FY 2019:

General Capital Improvement Fund (3001)

Pier Approach Project (15377)

\$400,000

This resolution shall become effective immediately upon its adoption.

APPROVALS:

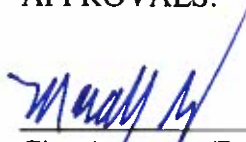
  
\_\_\_\_\_  
City Attorney (Designee)

  
\_\_\_\_\_  
Brejesh Prayman, P.E., ENV SP  
Engineering and Capital Improvements Director

  
\_\_\_\_\_  
Budget  
00432914 FINAL



City of St. Petersburg

# **St. Petersburg Janet Echelman Net Sculpture City Infrastructure**

---

**SKANSKA**

Table of Contents

<b>1</b>	Pier Approach GMP Addendum No. 7 for Janet Echelman Net Sculpture City Infrastructure Estimate Summary
<b>2</b>	Pier Approach GMP Addendum No. 7 for Janet Echelman Net Sculpture City Infrastructure Estimate
<b>3</b>	Document Log
<b>4</b>	Site Logistics Plan (Preliminary)
<b>5</b>	Janet Echelman Net Sculpture City Infrastructure Schedule
<b>6</b>	Appendix - A

**1**

**Pier Approach GMP  
Addendum No. 7 for  
Janet Echelman Net  
Sculpture City  
Infrastructure Estimate  
Summary**

- Executive Summary
- Cost Summary

1

Pier Approach GMP Addendum No. 7 for Janet Echelman Net Sculpture City Infrastructure Estimate

Executive Summary

Pier Approach GMP Addendum No. 7 for Janet Echelman Net Sculpture City Infrastructure Estimate is based upon the documents prepared by ARUP & W Architecture and their respective consultants (A/E Team) which are itemized in the Document List of this proposal. Further project scope definition has been developed by Skanska USA Building Inc., and various assumptions that are attached to this proposal.

Pier Approach GMP Addendum No. 7 for Janet Echelman Net Sculpture City Infrastructure

- Pier Approach GMP Addendum No. 7 for Janet Echelman Net Sculpture City Infrastructure Estimate: \$ 1,403,491

Project Description

Pier Approach GMP Addendum No. 7 for Janet Echelman Net Sculpture City Infrastructure Estimate includes pylon foundations, painting, erection of steel pylons, and net sculpture lighting and controls. Sitework modifications to facilitate this scope of work previously processed under authorization request number 24, see a copy of the authorization request 24 in the Appendix A for reference.

Skanska has developed and enclosed a Project Schedule, which indicates the schedule objectives for this scope.

- Pylon Installation Completion September 23<sup>rd</sup>, 2019  
\*Does not include net installation date as that is TBD

The following additional milestone dates are anticipated within the Project Schedule in order to achieve the dates above.

- NTP by City March 21<sup>st</sup>, 2019
- Permit Issued March 21<sup>st</sup>, 2019

**Cost Summary**

Following is the Cost Summary breakdown.



Pier Approach GMP  
Addendum No. 7 for Janet  
Echelman Net Sculpture City  
Infrastructure

2/22/2019

Description	Amount
1 Foundations	329,000
2 Installation of Artwork (pylon, concrete fill, tiebacks & sockets, Sculpture Netting, Cable & Eyelets Installation; sculpture netting cable and eyelet material furnished by others)	Below
3 Pylon Fabrication & Painting (Steel pylons are not galvanized, steel tie backs are galvanized) based on E&H 2-1-19 proposal	390,000
4 Erection of Pylons	Included Above
5 Erection of Net Sculpture Structural Cables and Net - Allowance	50,000
6 Concrete Fill of Pylons (Rough Estimate 48cy of concrete \$ 7,200; Pump and Place Equipment \$ 7,500; + sub markups \$ 10,000)	24,700
7 Field Paint Touch Up after Erection of Pylons	7,500
8 Plumbing (temp water)	In Foundations Price
9 Electrical Artwork Lighting & Controls (Ephesus Fixtures, controls, programming and commissioning - \$200,000)	365,178
10 Materials Testing (Terracon)	15,000
<b>Direct Cost</b>	<b>1,181,378</b>
<b>BUILDING PERMIT</b>	<b>NIC</b>
<b>CONSTRUCTION CONTINGENCY</b>	<b>41,348</b>
<b>SUBGUARD</b>	<b>17,363</b>
<b>CCIP % OF</b>	<b>36,210</b>
<b>Sub Total</b>	<b>1,276,299</b>
<b>GENERAL CONDITIONS</b>	
General Conditions (Lump Sum)	50,000
<b>CM FEES</b>	
Construction Management Fees	49,122
<b>INSURANCES &amp; BOND</b>	
Builders risk insurance	14,035
Performance & Payment Bond	14,035
<b>SUBTOTAL</b>	<b>1,403,491</b>
· OWNER'S CONTINGENCY FOR UNFORSEEN CONDITIONS	Excluded
· ARTWORK DESIGN	By Others
· PERMIT	By Others
· GEOTECHNICAL	By Others
· FURNISHING OF DESIGNED CABLE AND NETTING SYSTEM	By Others
<b>CONTRACT TOTALS</b>	<b>1,403,491</b>

## **2 Pier Approach GMP Addendum No. 7 for Janet Echelman Net Sculpture City Infrastructure Estimate**

- Introduction
- Insurances and Bonds
- Standard Qualifications
- Scope Specific Qualifications
- Allowances

**2**

## Pier Approach GMP Addendum No. 7 for Janet Echelman Net Sculpture City Infrastructure Estimate

### Introduction

This section of the Pier Approach GMP Addendum No. 7 for Janet Echelman Net Sculpture City Infrastructure describes modifications, conceptualizations, and exclusions.

No cost or time has been accounted for in the Pier Approach GMP Addendum No. 7 for Janet Echelman Net Sculpture City Infrastructure Estimate to address the issue of any items identified as “excluded”. For those items that are clarified, qualified and/or based upon an assumption, the Pier Approach GMP Addendum No. 7 for Janet Echelman Net Sculpture City Infrastructure Estimate reflects only the cost and time of the element as assumed or clarified.

Skanska’s Pier Approach GMP Addendum No. 7 for Janet Echelman Net Sculpture City Infrastructure Estimate is based upon the following:

1. Document log provided in Section 3.
2. Pier Approach GMP Addendum No. 7 for Janet Echelman Net Sculpture City Infrastructure Estimate dated February 22<sup>nd</sup>, 2019.
3. The qualifications mentioned in this proposal.

### Insurances and Bonds

#### Insurances:

- 1 Builders Risk Insurance is carried as an allowance.
- 2 Skanska shall furnish a Contractor Controlled Insurance Program ("CCIP") providing for the insurance coverages identified below. The cost of the CCIP is included in the Cost of the Work included in the Guaranteed Maximum Price calculation. The CCIP shall only cover on-site exposures and enrolled participants. Owner shall pay Skanska for CCIP premiums calculated as 2.58% of the Guaranteed Maximum Price:
  - On-Site General Liability, including Products & Completed Operations coverage for ten (10) years;
  - On-Site Workers Compensation and Employers Liability, including USL&H and Jones Act coverage;
  - \$100M in Excess Liability Limits Contractor Controlled Insurance Program (CCIP) Insurance is included at 2.58%.

## Bonds:

1. Payment and Performance Bond is carried as an allowance.
2. In lieu of bonding its Subcontractors, Skanska shall maintain subcontractor default insurance ("SDI") for the protection of the Skanska and the Owner against the default of Subcontractors. The cost of the SDI program will be included in the Cost of the Work included in the Guaranteed Maximum Price calculation. Owner shall pay Skanska for SDI premiums calculated as 1.42% of the Cost of the Work less General Conditions Costs for SDI.

## Coordination with other Contractors

This Pier Approach GMP Addendum No. 7 for Janet Echelman Net Sculpture City Infrastructure Estimate is based on the assumption that the Owner's contractors and all other parties performing construction work at the project site, not under direct contract with Skanska will:

- 1 Comply with Skanska's site specific safety program and maintain an injury free environment.
- 2 This Pier Approach GMP Addendum No. 7 for Janet Echelman Net Sculpture City Infrastructure Estimate is based on the expectation that all pre-purchased items to be provided by the Owner will be provided without delay or disruption per Skanska's schedule attached.
- 3 This Pier Approach GMP Addendum No. 7 for Janet Echelman Net Sculpture City Infrastructure Estimate assumes any separate contractors hired by the Owner will not interfere with the operation of Skanska.
- 4 This Pier Approach GMP Addendum No. 7 for Janet Echelman Net Sculpture City Infrastructure Estimate relies on and assumes Owner's other contractors working according to Skanska's project schedule, and will achieve system and area completion dates according to that schedule.
- 5 This Pier Approach GMP Addendum No. 7 for Janet Echelman Net Sculpture City Infrastructure Estimate relies on and assumes Owner's other contractors will perform work so as to not impact Skanska's ability to perform its work in accordance with its project logistics plan.
- 6 This Pier Approach GMP Addendum No. 7 for Janet Echelman Net Sculpture City Infrastructure Estimate relies on and assumes Owner's other contractors will provide detailed schedule, logistics, and technical information, when and as requested by Skanska so as to enable Skanska to maintain or accelerate elements of its schedule, maintain its overall schedule and achieve necessary milestone completion dates.
- 7 This Pier Approach GMP Addendum No. 7 for Janet Echelman Net Sculpture City Infrastructure Estimate relies on and assumes Owner's other contractors will provide and maintain insurance as required by the city, consistent with the requirements in Skanska's agreement with the City and providing Skanska the same protections as the City requires themselves such as insurance coverages, coverage limits, indemnify and hold Skanska harmless, waivers of subrogation, listing Skanska as an additional insured party of all policies, etc.

## Standard Qualifications

The following are the Standard Qualifications for the Pier Approach GMP Addendum No. 7 for Janet Echelman Net Sculpture City Infrastructure Estimate project:

- 1** We have included Lump Sum GCs & GRs.
- 2** In preparing the Pier Approach GMP Addendum No. 7 for Janet Echelman Net Sculpture City Infrastructure Estimate and the project schedule, Skanska relies on the construction documents to be fully designed, fully coordinated, code compliant, and accepted by the appropriate agencies and other applicable parties.
- 3** The cost of changes to the construction documents due to permit comments or conditions issued to Skanska following the delivery and acceptance of the Pier Approach GMP Addendum No. 7 for Janet Echelman Net Sculpture City Infrastructure Estimate are excluded.
- 4** Property, business operations and other taxes related to the Project Site and the operation of the project have not been included.
- 5** All sales tax on material is included.
- 6** Due to turnaround requirements dictated by the City and the Schedule, no advertising took place for this work and the work has been and will be priced by existing subcontractors already engaged on the project and awarded as change orders to their work.
- 7** All extended warranties included in the specifications, including the material/labor warranties, shall be assigned to Owner following the Skanska's one year repair/replacement obligation under the Contract. Thereafter, Skanska shall only be responsible for assisting reasonably the Owner in enforcing those warranties provided by the manufacturers, suppliers and subcontractors.
- 8** Skanska assumes unfettered access to the Project Site at all times. The Pier Approach GMP Addendum No. 7 for Janet Echelman Net Sculpture City Infrastructure Estimate does not anticipate any stoppage or interruption of work as a result of operations by others or other site restrictions or interferences. The City will provide written notice of any activities in downtown St. Petersburg that could result in disruptions to site ingress/egress and both parties will work cooperatively to resolve any potential disruptions.
- 9** All fees including utility company, public agency reviews or approvals and associated fees are not included.
- 10** The Owner shall be responsible for obtaining permits as set forth in Contract. Building permit costs are not included.
- 11** Pier Approach GMP Addendum No. 7 for Janet Echelman Net Sculpture City Infrastructure Estimate Schedule is based on the City's issuance of NTP (Notice to Proceed) on March 21<sup>st</sup>, 2019.
- 12** Use of union labor/prevailing wage is not included.
- 13** Delegated design is not included.
- 14** Pier Approach GMP Addendum No. 7 for Janet Echelman Net Sculpture City Infrastructure Estimate assumes the Architect/ Engineers design complies with all requirements prescribed in Owner standards or guidelines.
- 15** Pier Approach GMP Addendum No. 7 for Janet Echelman Net Sculpture City Infrastructure Estimate does not include any costs associated with reviews by insurance underwriters such as IRI or FM.

- ☒ “Time is of the essence” clauses are only applicable to the entire project’s Substantial Completion date.
- ☒ Pier Approach GMP Addendum No. 7 for Janet Echelman Net Sculpture City Infrastructure Estimate assumes there are no working hour restrictions.
- ☒ Estimate and schedule assumes an FAA review/ approval and permitting will be issued without any special requirements. Skanska has not included any provisions or cost related to special FAA requirements. Should the FAA dictate special construction or requirements the costs will be submitted as an extra.

## Scope Specific Qualifications

### **Pier Approach GMP Addendum No. 7 for Janet Echelman Net Sculpture City Infrastructure Assumptions and Clarifications:**

1. Permit submission and delivery by city.
2. Design excluded.
3. Delegated design excluded, except means and methods of 3<sup>rd</sup> party temporary supports.
4. Net sculpture (rope artwork) fabrication and delivery by others. Design documents for net and net installation not yet provided. Skanska has included an allowance of \$50,000 for installation.
5. Pylon and pile general note #3 on sheet S102, "...review and compare the structural drawings to the architectural, civil, and electrical drawings and notify the architect of any discrepancy", is excluded to the extent that contractor relies on the design and the drawings to be fully complete, code compliant, and coordinated between design disciplines. Contractor will advise if we notice discrepancies. However, if additional costs are incurred, as a result of correcting or coordinating design discrepancies they will be considered a changed condition and submitted as an added cost for reimbursement through owner contingency or change order.
6. Pylon and pile general note #6 on sheet S102, "...this includes shoring and bracing as needed or determined by an independent engineer". Contractor relies on pylons to be self-supporting once erected and anchored in place. Note #5 is limited to the time the pylon is being erected prior to permanent anchor.
7. Pylon and piles: erection, construction sequencing, and lateral stability general notes on sheet S102, apply only to the time the pylon is being erected up, until final anchoring.
8. Pylon and piles shop drawing note 4A on sheet S102, "contractor shall submit for review a site utility layout using structural drawings as background." Contractor relies on the designers to have already issued coordinated design documents. Contractor will only submit if an as-built deviation from site utility design layout has taken place.
9. Special inspections are by the city.
10. Structural observation general note 3A on sheet S102, contractor cannot provide one week notice prior to pouring to observe rebar. Contractor will coordinate, as best as possible, one week in advance.
11. As of 2-1-2019, the steel proposal is issued for acceptance within 30 calendar days. After 30 days, steel price may be revisited to adjust for fluctuations in material and other costs.
12. Estimate is based on the 4 pylons being SP6 blast cleaned and primed with 1 coat (5.0 mils DFT) of Sherwin Williams Zinc Clad 4100 (organic). After priming, the pylons will receive one intermediate coat (7.5 mils DFT) of Sherwin Williams Macropoxy 646 and one top coat (3.0 mils DFT) of Sherwin Williams Acrolon 100. All framing other than 4 pylons shall be hot-dip galvanized.
13. No assumptions or provisions are included relative to connection or additional reinforcing for moment or seismic design beyond specific material, welds, and bolts shown on structural drawings. All members that connect are assumed to use standard connections to transfer loads/ forces without requirement of stiffeners or double plates, unless specifically shown.
14. It is not guaranteed that the taper-form cones atop pylons 1 and 3 will provide a perfectly smooth surface due to the bends required to form the plate in such a manner. The design team must be aware that certain marks and "break lines" resultant from the forming of the plate may be impossible to remove and/ or conceal.
15. Paint is based on a "P2" endorsement, not "P1" sophisticated paint endorsement.
16. Steel inspection costs are excluded.
17. Filling of weep holes in galvanized material is excluded.
18. Proposal based on steel stored materials and fabrication progress billings being allowed by the City.

19. Modification costs for light poles to be modified are included. Modified light poles include LP120, LP121, LP122, LP130, LP131, LP132, LP134, LP145, and LP147. Per ARUP E-mail dated 2/12/19, ARUP confirmed that pole manufacturer has approved and confirmed engineering. See Appendix documents for backup.
20. Per Bulletin # 2, light pole, LP008, LP009, LP29, LP141, and LP150 were deleted.
21. Per Bulletin #2, light pole, LP001, LP002, L003, LP004, LP005, LP006, LP007 have been added.
22. Homeruns, dedicated control conduit, and wire has been included at each pole. Contractor relies on engineer of record to have confirmed that the pole design can accept and hold all of the different systems and conduit for the same within the poles, Pier approach lighting power circuits, Net Sculpture lighting circuits, and the Net Sculpture control cable and conduit.
23. Contractor relies on ARUP having confirmed and gone through engineering measures to ensure that there are no issues exist between the Echelman lights and the existing Pier Approach lighting poles to which they will be mounted. These pole modifications include the wiring and conduit routing within each.
24. CTL testing has been included for the foundations.
25. Contractor assumes no responsibility for the caisson design, the determination of bearing capacity of soil or rock strata, or for any other soil evaluation services, geotechnical engineer to monitor the work.
26. For the purpose of measurement of pay quantities, unit priced lengths of shafts shall be paid against the as-built aggregate axial lengths of each shaft diameter from Grade/ Drill platform elevation to design tip elevation.
  - a. The following add prices shall be applied to all aggregate pay lengths of shafts constructed in excess of the base quantities detailed in the table above:
    - i. 36" Diam: \$500/ LF                      66" Diam: \$600/ LF
  - b. The following deduct prices shall be applied to all aggregate pay lengths of shafts not constructed below the base quantities detailed in the table above:
    - i. 36" Diam: \$0/ LF                      66" Diam: \$0/ LF
27. Voided subsurface conditions have been excluded, voided subsurface includes hollow areas outside foundation footprint that would require unknown volume of anticipated concrete/ grout, etc..to fill.
28. Sixty-minute concrete placement time after introduction of water has been excluded. Subcontractor to submit a concrete mix design for engineer approval.
29. Variation from center for concrete and reinforcing cage not to exceed 3".
30. Contractor has included HRC 670 Series T-Heads and not Lenton Terminators or HRC-555 or 100 Series T-Headed bars.
31. Without restrictions, the contractor intends to use a combination of temporary casing and natural slurry to excavate the shafts; and tremie methods to pour each excavated shaft within 24-hours of the shaft being excavated to design tip. If the shaft is not scheduled to be poured within 24-hours, the contractor will excavate no deeper than 5-feet above the design tip until the shaft enters the 24-hr pour cycle.
32. The contractor will submit a concrete mix designed to have a minimum slump of 5" through the removal of casing and completion of each shaft. The contractor will provide and place concrete and has included 130% neatline concrete volume. The volume is calculated using grade, tip, and shaft diameter as the neatline dimensions of each shaft. Should actual concrete delivered to the jobsite exceed the volume, then the contractor will be paid additional compensation at the rate of \$180/CY delivered to the site. The contractor will not vibro-consolidate any of this concrete.
33. Underground and overhead obstruction removal (i.e. tree stumps/ limbs, old slabs, footings, riprap, piling, bridges, boulders, etc.). The contractor will be reimbursed \$1500/hr/drill for obstructions.
34. Skanska assumes pylon foundation and tieback foundations have been coordinated around several deadman tie backs and deadman. Should any conflicts arise, damages, or delays take place Skanska will recognize these are unforeseen conditions and submit a request for additional compensation through



owner contingency or change order.

35. The work covered by this project may, by its nature, cause some unavoidable earth movement that could damage surrounding utilities, pavements, or structures. As any such movement is inherent to the nature of the work, contractor will not be liable for such movements or distress caused by such movements unless caused by the gross neglect of the contractor.
36. The contractor will not be liable for the disturbance to existing structures and their inhabitants on or near the site.
37. Bulletin 2 exclusions include all rocks, cap stones, pile cap cut offs, stepping stones, retaining wall rocks, beach boulders, hammocks, sundeck, and tree 11 and 106 relocations.

## ALLOWANCES

In order to provide the Pier Approach GMP Addendum No. 7 for Janet Echelman Net Sculpture City Infrastructure Estimate per Owner's requested delivery date, a number of cost allowances had to be established. These allowances are intended to provide for all direct construction costs associated with each of these items. Indirect costs are not included in allowances.

- 1 Builders Risk: \$14,035
- 2 Bond: \$14,035
- 3 Materials Testing: \$15,000
- 4 Erection of Net Sculpture Structural Cables and Net: \$50,000

## **3** Document Log

The Document Log that follows represents the information that forms the Pier Approach GMP Addendum No. 7 for Janet Echelman Net Sculpture City Infrastructure Estimate and associated clarifications defined herein.

## **EXHIBIT “B”**

Attachment to **Subcontract/Purchase Order No. xxxxxx-xxx** dated **mm dd, year**, by and between **[insert full legal name of subcontractor/seller]** and **SKANSKA USA BUILDING INC.** for **[insert trade work/goods and services]** at **[insert project name and location]**.

### **ECHELMAN SCULPTURE PYLON AND FOUNDATION 100% DRAWINGS**

<b>Drawing No.</b>	<b>Drawing Title</b>	<b>Revision No.</b>	<b>Date</b>	<b>Set Name</b>
S001	ABBREVIATIONS, DRAWING LIST AND LEGEND	0	01/11/2019	PERMIT SET
S102	PYLON GENERAL NOTES	0	01/11/2019	PERMIT SET
S103	PYLON GENERAL NOTES	0	01/11/2019	PERMIT SET
S201	SITE PLAN	0	01/11/2019	PERMIT SET
S212	FOUNDATION LAYOUT PLAN	0	01/11/2019	PERMIT SET
S291	PYLON ELEVATIONS	0	01/11/2019	PERMIT SET
S292	PYLON ELEVATIONS	0	01/11/2019	PERMIT SET
S301	FOUNDATION DETAILS	0	01/11/2019	PERMIT SET
S551	STEEL PYLON DETAILS	0	01/11/2019	PERMIT SET
S552	STEEL PYLON DETAILS	0	01/11/2019	PERMIT SET

### **ECHELMAN SCULPTURE PYLON AND FOUNDATION 100% SPECIFICATIONS**

<b>Specification No.</b>	<b>Specification Title</b>	<b>Revision No.</b>	<b>Date</b>	<b>Set Name</b>
03300	CAST-IN-PLACE CONCRETE	0	01/11/2019	PERMIT SET
033100	PYLON GENERAL NOTES	0	01/11/2019	PERMIT SET
033200	CONCRETE REINFORCEMENT	0	01/11/2019	PERMIT SET
051200	STRUCTURAL STEEL FRAMING	0	01/11/2019	PERMIT SET
051213	ARCHITECTURALLY EXPOSED STRURAL STEEL (AESS)	0	01/11/2019	PERMIT SET
316329	DRILLED SHAFTS	0	01/11/2019	PERMIT SET

### **ECHELMAN SCULPTURE LIGHTING REPORT #2**

<b>Report Sheet</b>	<b>Specification Title</b>	<b>Revision No.</b>	<b>Date</b>	<b>Report Name</b>
PG. 1	COVER	1	12/14/2018	JANET ECHELMAN LIGHTING REPORT #2
PG. 2	STUDIO ECHELMAN PRELIMINARY DESIGN	1	12/14/2018	JANET ECHELMAN LIGHTING REPORT #2
PG. 3	LUMINAIRE BEAM ANGLE STUDY	1	12/14/2018	JANET ECHELMAN LIGHTING REPORT #2
PG. 4	LUMINAIRE BEAM ANGLE STUDY	1	12/14/2018	JANET ECHELMAN LIGHTING REPORT #2
PG. 5	LUMINAIRE LOCATIONS & QUANTITY	1	12/14/2018	JANET ECHELMAN LIGHTING REPORT #2
PG. 6	LUMINAIRE LOCATIONS & QUANTITY	1	12/14/2018	JANET ECHELMAN LIGHTING REPORT #2
PG. 7	POLE TYPES – SPEC BY ARUP	1	12/14/2018	JANET ECHELMAN

## **EXHIBIT “B”**

Attachment to **Subcontract/Purchase Order No. xxxxxx-xxx** dated **mm dd, year**, by and between **[insert full legal name of subcontractor/seller]** and **SKANSKA USA BUILDING INC.** for **[insert trade work/goods and services]** at **[insert project name and location]**.

PG. 8	LUMINAIRE TYPES – SPEC BY EPHEBUS		12/14/2018	LIGHTING REPORT #2
		1		JANET ECHELMAN
PG. 9	CONTROLS EQUIPMENT – SPEC BY		12/14/2018	LIGHTING REPORT #2
	EPHEBUS/ETC	1		JANET ECHELMAN
PG. 10	CONTACT		12/14/2018	LIGHTING REPORT #2
		1		JANET ECHELMAN
				LIGHTING REPORT #2

### **ADDITIONAL REFERENCE DOCUMENTS – TECHNICAL SPECIFICATIONS & CUTSHEETS**

<b>Cutsheet No.</b>	<b>Technical Data Sheet</b>	<b>Revision No.</b>	<b>Date Provided</b>	<b>Set Name</b>
1	1212 DMX/RDM ISOLATED SPLITTER	0	12/14/2018	NA
2	UNISON MOSAIC TOUCHSCREEN	0	12/14/2018	NA
3	HEARTLAND CENTRAL BAY ENCLOSURE	0	12/14/2018	NA
4	UNISON MOSAIC 512 CHANNEL	0	12/14/2018	NA
5	ST. PETERSBURG PIER SCULPTURE SYSTEM RISER LAYOUT	0	12/14/2018	NA

## **EXHIBIT “B”**

Attachment to **Subcontract/Purchase Order No. xxxxxx-xxx** dated **mm dd, year**, by and between **[insert full legal name of subcontractor/seller]** and **SKANSKA USA BUILDING INC.** for **[insert trade work/goods and services]** at **[insert project name and location]**.

### **PIER APPROACH DRAWINGS – BULLETIN 02**

<b>Drawing No.</b>	<b>Drawing Title</b>	<b>Revision No.</b>	<b>Date</b>	<b>Set Name</b>
G-0.10	DRAWING INDEX	3	12/14/2018	BULLETIN 2
C-1.00	COVER SHEET	2	02/01/2017	ADDENDUM 3
C-1.01	GENERAL NOTES	0	11/01/2017	100% CD
C-1.05	GFY SURVEY – PIER APPROACH	0	11/01/2017	100% CD
C-1.06	GFY SURVEY – THE PIER	0	11/01/2017	100% CD
C-1.07	GFY SURVEY – SPA BEACH	0	11/01/2017	100% CD
C-1.08	GFY SURVEY – THE LENS	0	11/01/2017	100% CD
C-2.00	SWPPP PHASE I	1	03/21/2018	ADDENDUM 3
C-2.01	SWPPP PHASE II	1	03/21/2018	ADDENDUM 3
C-2.02	SWPPP DETAILS	0	11/01/2017	100% CD
C-2.10	PAVEMENT PLAN	1	03/21/2018	ADDENDUM 3
C-3.00	MASTER KEY SITE PLAN		01/05/2018	VE PRICING
		1		ADDENDUM
C-3.01	DEMOLITION PLAN		01/05/2018	VE PRICING
		1		ADDENDUM
C-3.02	DEMOLITION PLAN		01/05/2018	VE PRICING
		1		ADDENDUM
C-3.03	DEMOLITION PLAN		01/05/2018	VE PRICING
		1		ADDENDUM
C-3.04	DEMOLITION PLAN		01/05/2018	VE PRICING
		1		ADDENDUM
C-3.05	DEMOLITION PLAN		01/05/2018	VE PRICING
		1		ADDENDUM
C-4.00	MASTER KEY GRADING PLAN	1	03/21/2018	ADDENDUM 3
C-4.01	SITE PLAN	2	03/21/2018	ADDENDUM 3
C-4.02	SITE PLAN	3	03/21/2018	BULLETIN 2
C-4.03	SITE PLAN	2	03/21/2018	BULLETIN 2
C-4.04	SITE PLAN	2	03/21/2018	ADDENDUM 3
C-4.05	SITE PLAN	2	03/21/2018	ADDENDUM 3
C-4.06	INTERSECTION PLAN	0	11/01/2017	100% CD
C-5.00	MASTER KEY GRADING PLAN	1	03/21/2018	ADDENDUM 3
C-5.01	GRADING PLAN	2	03/21/2018	ADDENDUM 3
C-5.02	GRADING PLAN	3	03/21/2018	BULLETIN 2
C-5.03	GRADING PLAN	3	03/21/2018	BULLETIN 2
C-5.04	GRADING PLAN	4	09/07/2018	BULLETIN 1
C-5.05	GRADING PLAN	4	12/14/2018	BULLETIN 2
C-5.06	GRADING PLAN	2	03/21/2018	ADDENDUM 3
C-5.10	STORM DRAINAGE SCHEDULE	3	12/14/2018	BULLETIN 2
C-5.11	STORM DRAINAGE DETAILS	2	12/14/2018	BULLETIN 2

## **EXHIBIT “B”**

Attachment to **Subcontract/Purchase Order No. xxxxxx-xxx** dated **mm dd, year**, by and between **[insert full legal name of subcontractor/seller]** and **SKANSKA USA BUILDING INC.** for **[insert trade work/goods and services]** at **[insert project name and location]**.

C-5.12	CITY OF ST. PETER DRAINAGE DETAILS	0	02/23/2018	ADDENDUM 2
C-5.13	CITY OF ST. PETER DRAINAGE DETAILS 2	0	02/23/2018	ADDENDUM 2
C-6.00	MASTER KEY UTILITY PLAN	2	02/23/2018	ADDENDUM 3
C-6.00	MASTER KEY UTILITY PLAN	2	02/23/2018	ADDENDUM 3
C-6.01	UTILITY PLAN	3	02/23/2018	ADDENDUM 3
C-6.02	UTILITY PLAN	5	12/14/2018	BULLETIN 2
C-6.03	UTILITY PLAN	5	12/14/2018	BULLETIN 2
C-6.04	UTILITY PLAN	4	09/07/2018	BULLETIN 1
C-6.05	UTILITY PLAN	5	12/14/2018	BULLETIN 2
C-7.00	CITY OF ST. PETER DETAILS	1	01/05/2018	ADDENDUM 1
C-7.01	CITY OF ST. PETER DETAILS	1	01/05/2018	ADDENDUM 1
EX-2	PROPOSED UTILITY COLOR MAP	2	02/23/2018	ADDENDUM 3
L-0.01	SITE LANDSCAPE NOTES	2	02/23/2018	ADDENDUM 3
L-1.00	KEY PLAN – LAYOUT & MATERIAL PLAN	4	12/14/2018	BULLETIN 2
L-1.10	KEY PLAN – LAYOUT & MATERIAL PLAN	4	12/14/2018	BULLETIN 2
L-1.20	KEY PLAN – LAYOUT & MATERIAL PLAN	4	12/14/2018	BULLETIN 2
L-1.30	KEY PLAN – LAYOUT & MATERIAL PLAN	5	12/14/2018	BULLETIN 2
L-1.40	KEY PLAN – LAYOUT & MATERIAL PLAN	5	12/14/2018	BULLETIN 2
L-1.50	KEY PLAN – LAYOUT & MATERIAL PLAN	5	12/14/2018	BULLETIN 2
TM-1.00	TREE MITIGATION INDEX	0	11/01/2017	100% CD
TM-1.01	TREE MITIGATION PLAN	1	01/05/2018	VE PRICING ADDENDUM
TM-1.02	TREE MITIGATION PLAN	0	11/01/2017	100% CD
TM-1.03	TREE MITIGATION PLAN	2	11/01/2017	BULLETIN 2
TM-1.04	TREE MITIGATION PLAN	0	11/01/2017	100% CD
TM-1.05	TREE MITIGATION PLAN	2	09/07/2018	BULLETIN 1
TM-1.06	TREE MITIGATION PLAN	3	09/07/2018	BULLETIN 2
TM-1.07	TREE MITIGATION PLAN	1	01/05/2018	VE PRICING ADDENDUM
L-2.00	LANDSCAPE INDEX PLAN	0	11/01/2017	100% CD
L-2.01.0	LANDSCAPE PLAN-TREE LAYOUT	1	01/05/2018	VE PRICING ADDENDUM
L-2.01.1	LANDSCAPE PLAN – UNDERSTORY	1	01/05/2018	VE PRICING ADDENDUM
L-2.02.0	LANDSCAPE PLAN- TREE LAYOUT	2	12/14/2018	BULLETIN 2
L-2.02.1	LANDSCAPE PLAN-UNDERSTORY	2	12/14/2018	BULLETIN 2
L-2.03.0	LANDSCAPE PLAN –TREE LAYOUT	2	12/14/2018	BULLETIN 2
L-2.03.1	LANDSCAPE PLAN – UNDERSTORY	1	12/14/2018	BULLETIN 2

## **EXHIBIT “B”**

Attachment to **Subcontract/Purchase Order No. xxxxxx-xxx** dated **mm dd, year**, by and between **[insert full legal name of subcontractor/seller]** and **SKANSKA USA BUILDING INC. for [insert trade work/goods and services] at [insert project name and location].**

L-2.04.0	LANDSCAPE PLAN- TREE LAYOUT	3	09/07/2018	BULLETIN 1
L-2.04.1	LANDSCAPE PLAN – UNDERSTORY	3	09/07/2018	BULLETIN 1
L-2.05.0	LANDSCAPE PLAN- TREE LAYOUT	3	09/07/2018	BULLETIN 1
L-2.05.1	LANDSCAPE PLAN – UNDERSTORY	3	09/07/2018	BULLETIN 1
L-2.06	LANDSCAPE SCHEDULE	4	12/14/2018	BULLETIN 2
L-2.50	LANDSCAPE NOTES	0	11/01/2017	100%CD
L-2.51	LANDSCAPE DETAILS	0	11/01/2017	100%CD
L-3.00	KEY PLAN-CONCRETE LAYOUT PLAN	4	12/14/2018	BULLETIN 2
L-3.10	CONCRETE LAYOUT PLAN	4	12/14/2018	BULLETIN 2
L-3.20	CONCRETE LAYOUT PLAN	4	12/14/2018	BULLETIN 2
L-3.30	CONCRETE LAYOUT PLAN	4	12/14/2018	BULLETIN 2
L-3.40	CONCRETE LAYOUT PLAN	4	12/14/2018	BULLETIN 2
L-3.50	CONCRETE LAYOUT PLAN	4	12/14/2018	BULLETIN 2
L-4.00	SITE SECTIONS	3	12/14/2018	BULLETIN 2
L-5.20	KEY PLAN –FURNITURE PLAN	4	12/14/2018	BULLETIN 2
L-5.21	FURNITURE PLAN	3	12/14/2018	BULLETIN 2
L-5.22	FURNITURE PLAN	3	12/14/2018	BULLETIN 2
L-5.23	FURNITURE PLAN	4	12/14/2018	BULLETIN 2
L-5.24	FURNITURE PLAN	4	12/14/2018	BULLETIN 2
L-5.25	FURNITURE PLAN	4	12/14/2018	BULLETIN 2
L-6.00	ENLARGEMENT PLAN – THE LINK NORTH	2	12/14/2018	BULLETIN 2
L-6.10	ENLARGEMENT PLAN – THE LINK SOUTH	2	01/05/2018	ADDENDUM 1
L-6.20	ENLARGEMENT PLAN – GARDEN	1	12/14/2018	BULLETIN 2
L-6.21	ENLARGEMENT PLAN – PLAYGROUND	1	12/14/2018	BULLETIN 2
L-6.22	ENLARGEMENT PLAN – PLAYGROUND 2	0	12/14/2018	BULLETIN 2
L-6.30	ENLARGEMENT PLAN – VIEW EDGE AND TREE RING PRECAST	2	12/14/2018	BULLETIN 2
L-6.31	ELEVATIONS – VIEW EDGE	2	12/14/2018	BULLETIN 2
L-6.40	ENLARGEMENT PLAN – OVERLOOK	3	09/07/2018	BULLETIN 1
L-6.50	OVERLOOK – SECTIONS + ELEVATIONS	3	09/07/2018	BULLETIN 1
L-6.60	SUNDECK + BRIDGE - ENLARGEMENT PLAN	3	12/14/2018	BULLETIN 2
L-6.61	BRIDGE ENLARGEMENT PLAN	1	12/14/2018	BULLETIN 2
L-6.62	WETPOND BRIDGE ENLARGEMENT PLAN	1	12/14/2018	BULLETIN 2
L-7.00	TYPICAL SITE PAVEMENT DETAILS	3	12/14/2018	BULLETIN 2
L-7.01	TYPICAL PLAYGROUND DETAILS	0	12/14/2018	BULLETIN 2
L-7.10	TYPICAL STAIR DETAILS	3	12/14/2018	BULLETIN 2
L-7.11	TYPICAL CAST IN PLACE VIEW EDGE DETAILS	1	01/05/2018	ADDENDUM 1
L-7.12	TYPICAL PRECAST DETAILS	0	01/05/2018	ADDENDUM 1



## **EXHIBIT “B”**

Attachment to **Subcontract/Purchase Order No. xxxxxx-xxx** dated **mm dd, year**, by and between **[insert full legal name of subcontractor/seller]** and **SKANSKA USA BUILDING INC. for [insert trade work/goods and services] at [insert project name and location].**

L-7.20	TYPICAL OVERLOOK DETAILS	3	12/14/2018	BULLETIN 2
L-7.21	TYPICAL SUNDECK+REMOVABLE TREE PIT DETAILS	2	12/14/2018	BULLETIN 2
L-7.30	TYPICAL FURNITURE DETAILS	2	12/14/2018	BULLETIN 2
I-2.00	IRRIGATION INDEX PLAN	2	09/07/2018	BULLETIN 1
I-2.01	IRRIGATION PLAN	2	09/07/2018	BULLETIN 1
I-2.02	IRRIGATION PLAN	3	12/14/2018	BULLETIN 2
I-2.03	IRRIGATION PLAN	3	12/14/2018	BULLETIN 2
I-2.04	IRRIGATION PLAN	3	09/07/2018	BULLETIN 1
I-2.05	IRRIGATION PLAN	3	09/07/2018	BULLETIN 1
I-2.50	IRRIGATION NOTES	4	12/14/2018	BULLETIN 2
A-0.1	DRAWING LEGEND, BUILDING DATA AND INDEX	1	02/23/2018	ADDENDUM 3
A-1.10	MARKET PROMENADE SITE PLAN	0	11/01/2017	100% CD
A-2.10	SHADE STRCUTURE PLANS	1	1/30/2019	BULLETIN 03
A-2.20	MARKET STALLS & BENCHES	2	1/30/2019	BULLETIN 03
A-3.0	SHADE STRUCTURE ELEVATIONS	1	02/23/2018	ADDENDUM 3
A-3.1	SHADE STRUCTURE SECTIONS	0	11/01/2017	100% CD
A-3.10	MARKET SHADE STRUCTURE SOLAR STUDY	0	11/01/2017	100% CD
A-3.11	SHADE STRUCTURE DETAILS	0	02/23/2018	ADDENDUM 3
A-3.20	MARKET PROMENADE MARKET STALL PERSPECTIVE	1	02/23/2018	ADDENDUM 3
A-4.1	COLUMN SET OUT	0	11/01/2017	100% CD
A-4.2	PV RAIL SET OUT	0	11/01/2017	100% CD
A-4.3	PV PANEL SET OUT	0	11/01/2017	100% CD
S-0.01	ABBREVIATIONS AND DRAWING LIST	0	11/01/2017	100% CD
S-0.02	GENERAL NOTES	0	11/01/2017	100% CD
S-1.01	KEY PERSPECTIVE AND FOUNDATION PLAN	3	02/23/2018	ADDENDUM 3
S-1.02	CANOPY ROOF PLAN	2	02/23/2018	ADDENDUM 2
S-2.00	ELEVATIONS	0	11/01/2017	100% CDS
L-5.00	SITE LIGHTING PLAN	2	12/14/2018	BULLETIN 2
L-5.01	LIGHTING CALCULATION PAN	0	11/01/2017	100% CD
L5.02	L POLE SCHEDULE	2	12/14/2018	BULLETIN 2
L-5.03	L LUMINARE SCHEDULE	3	12/14/2018	BULLETIN 2
L-5.10	L LIGHTING DETAILS	0	11/01/2017	100% CD
L-5.11	L LIGHTING DETAILS	0	11/01/2017	100% CD
L-5.12	L CATENARY LIGHTING DETAILS	1	01/05/2018	ADDENDUM 1
L-5.20	LIGHTING PLAN FAMILY PARK	0	12/14/2018	BULLETIN 2
L-5.30	L LIGHTING PLAN PARKING & OVERLOOK	1	12/14/2018	BULLETIN 2
E-0.00	ELECTRICAL LEGEND	0	11/01/2017	100% CD
E-1-00	OVERALL SITE PLAN - ELECTRICAL	3	12/14/2018	BULLETIN 2
E-1.10	ENLARGED SITE PLAN – ELECTRICAL	1	01/05/2018	ADDENDUM 1

## **EXHIBIT “B”**

Attachment to **Subcontract/Purchase Order No. xxxxxx-xxx** dated **mm dd, year**, by and between **[insert full legal name of subcontractor/seller]** and **SKANSKA USA BUILDING INC.** for **[insert trade work/goods and services]** at **[insert project name and location]**.

---

	DEMOLITION			
E-1.20	ENLARGED SITE PLAN – ELECTRICAL DEMOLITION	1	01/05/2018	ADDENDUM 1
E-1.30	ENLARGED SITE PLAN – ELECTRICAL DEMOLITION	1	01/05/2018	ADDENDUM 1
E-1.40	ENLARGED SITE PLAN – ELECTRICAL DEMOLITION	0	11/01/2017	100% CD
E-1.50	ENLARGED SITE PLAN – ELECTRICAL DEMOLITION	0	11/01/2017	100% CD
E-2.10	ENLARGED SITE PLAN – ELECTRICAL RENOVATION	2	12/14/2018	BULLETIN 2
E-2.20	ENLARGED SITE PLAN – ELECTRICAL RENOVATION	2	12/14/2018	BULLETIN 2
E-2.30	ENLARGED SITE PLAN – ELECTRICAL RENOVATION	3	12/14/2018	BULLETIN 2
E-2.40	ENLARGED SITE PLAN – ELECTRICAL RENOVATION	2	09/07/2018	BULLETIN 1
E-2.50	ENLARGED SITE PLAN – ELECTRICAL RENOVATION	4	12/14/2018	BULLETIN 2
E-3.01	POWER RISER DIAGRAM AND SCHEDULE	1	12/14/2018	BULLETIN 2
E-3.02	POWER RISER DIAGRAM AND SCHEDULE	2	12/14/2018	BULLETIN 2
E-3.03	POWER RISER DIAGRAM AND SCHEDULE	2	12/14/2018	BULLETIN 2
E-3.04	POWER RISER DIAGRAM AND SCHEDULE	1	12/14/2018	BULLETIN 2
E-3.05	POWER RISER DIAGRAM AND SCHEDULE	2	09/07/2018	BULLETIN 1
E-4.00	MARKET STRUCTURE PV ARRAY	0	11/01/2017	100% CD

## **EXHIBIT “B”**

Attachment to **Subcontract/Purchase Order No. xxxxxx-xxx** dated **mm dd, year**, by and between **[insert full legal name of subcontractor/seller]** and **SKANSKA USA BUILDING INC.** for **[insert trade work/goods and services]** at **[insert project name and location]**.

### **PIER APPROACH SPECIFICATIONS**

<b>Specification</b>	<b>Description</b>	<b>Issued Date</b>
01 23 00	ALTERNATES	11/01/2017
01 25 00	SUBSTITUTION PROCEDURES	11/01/2017
01 31 00	PROJECT MANAGEMENT AND CORDINATION	11/01/2017
01 33 00	SUBMITTAL PROCEDURES	11/01/2017
01 40 00	QUALITY REQUIREMENTS	11/01/2017
01 50 00	TEMPORARY FACILITIES AND CONTROLS	11/01/2017
01 56 39	TREE AND PLANT PROTECTION	11/01/2017
01 60 00	PRODUCT REQUIREMENTS	11/01/2017
01 73 00	EXECUTION	11/01/2017
01 74 19	CONSTRUCTION WASTE MANAGEMENT AND DISPOSAL	11/01/2017
01 77 00	CLOSEOUT PROCEDURES	11/01/2017
01 78 23	OPEATION AND MAINTENANCE DATA	11/01/2017
01 78 39	PROJECT RECORD DOCUMENTS	11/01/2017
01 79 00	DEMONSTRATION AND TRAINING	11/01/2017
02 41 19	SELECTIVE DEMOLITION	11/01/2017
03 30 00	CAST-IN-PLACE CONCRETE AWARDED SPO	11/01/2017
03 33 00.01	MARKET CONCRETE FOOTING	11/01/2017
03 45 00	PRECAST ARCHITECTURAL CONCRETE	11/01/2017
03 45 00.01	MARKET PRECAST ARCHITECTURAL CONCRETE	11/01/2017
04 21 00	CONCRETE UNIT MASONRY	11/01/2017
05 05 13	FACTORY-APPLIED METAL COATINGS	11/01/2017
05 12 00	STRUCTURAL STEEL	11/01/2017
05 50 00	METAL FABRICATIONS	11/01/2017
05 52 13	PIPE AND TUBE RAILINGS	11/01/2017
06.10.00	ROUGH CARPENTRY	11/01/2017
06 15 00	EXTERIOT WOOD DECKING	11/01/2017
09 96 00	HIGH PERFORMANCE PAINTING AND COATING	03/21/2018
09 96 23	GRAFFITI RESISTANT COATINGS	03/21/2018
10 80 00	SPECIALITIES	11/01/2017
12 93 00	SITE FURNISHINGS	12/14/2018
26 01 00	BASIC ELECTRICAL REQUIREMENTS	11/01/2017
26 05 00	COMMON WORK RESULTS FOR ELECTRICAL	11/01/2017
26 05 19	CONDUCTORS AND CABLES	11/01/2017
26 05 26	GROUNDING AND BONDING	11/01/2017
26 05 29	HANGERS AND SUPPORTS FOR ELECTRICAL SYSTEMS	11/01/2017
26 05 33	RACEWAYS AND BOXES	11/01/2017

## **EXHIBIT “B”**

Attachment to **Subcontract/Purchase Order No. xxxxxx-xxx** dated **mm dd, year**, by and between **[insert full legal name of subcontractor/seller]** and **SKANSKA USA BUILDING INC. for [insert trade work/goods and services] at [insert project name and location].**

26 05 53	ELECTRICAL IDENTIFICATION	11/01/2017
26 22 00	LOW-VOLTAGE TRANSFORMERS	11/01/2017
26 24 16	PANELBOARDS	11/01/2017
26 27 26	WIRING DEVICES	11/01/2017
26 28 16	ENCLOSED SWITCHES AND CIRCUIT BREAKER	11/01/2017
26 43 13	SURGE PROTECTION DEVICES	11/01/2017
<b>26 55 00</b>	<b>SPECIAL PURPOSE LIGHTING</b>	<b>12/14/2018</b>
26 56 00	EXTERIOR LIGHTING	11/01/2017
26 56 00	EXTERIOR LIGHTING LUMINAIRE SPECIFICATIONS SHEETS	11/01/2017
31 00 00	EARTHWORK	11/01/2017
31 11 00	CLEARING AND GRUBBING	11/01/2017
32 13 16	DECORATIVE CONCRETE PAVING	11/01/2017
32 13 15	CONCRETE JOINT SEALERS	11/01/2017
32 18 20	SYNTHETIC GRASS PLAY SURFACING SYSTEM	12/14/2018
32 31 13	CUSTOM FENCES AND GATES	11/01/2017
32 91 13	STRUCTURAL SOIL	11/01/2017

## 4 Site Logistics Plan

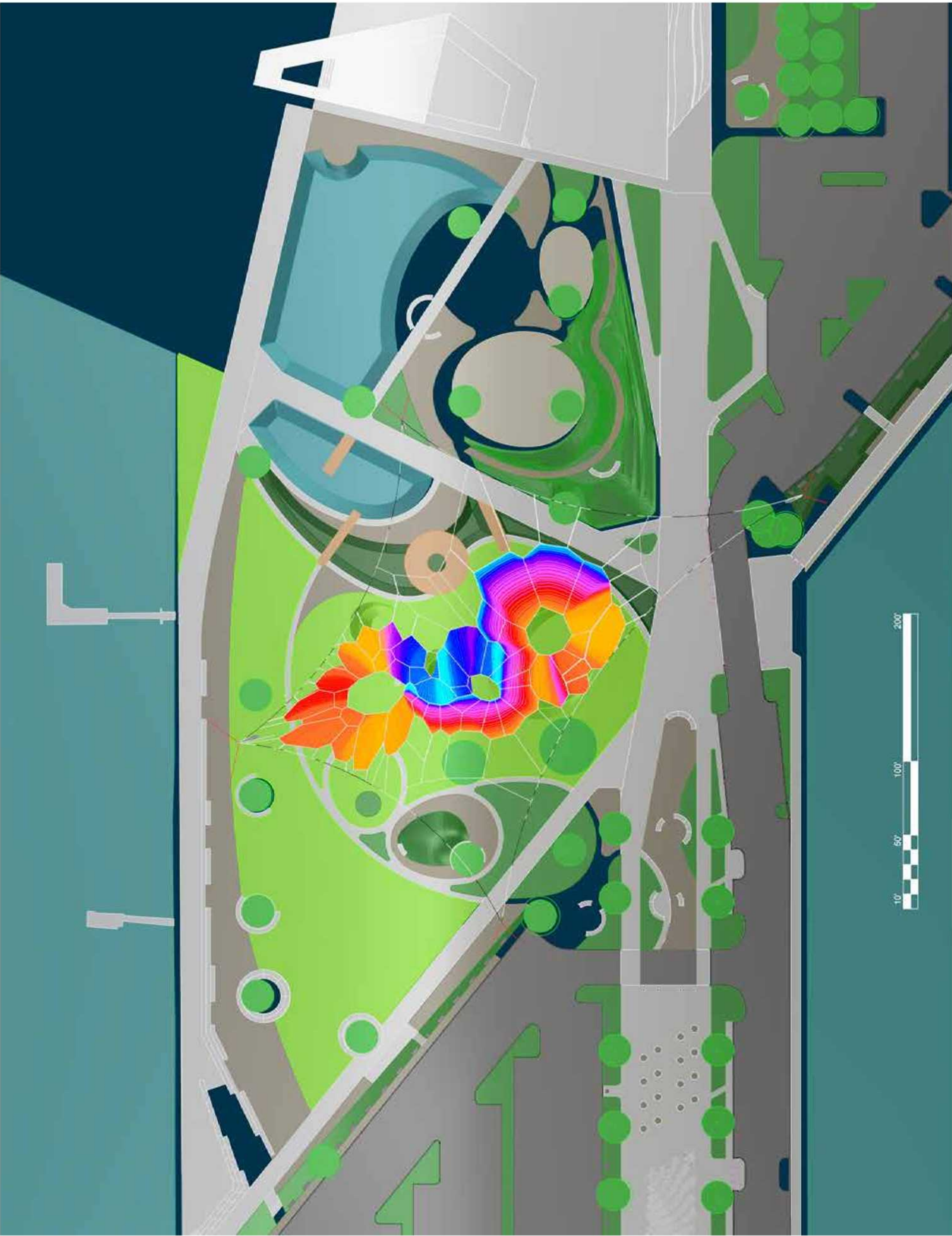



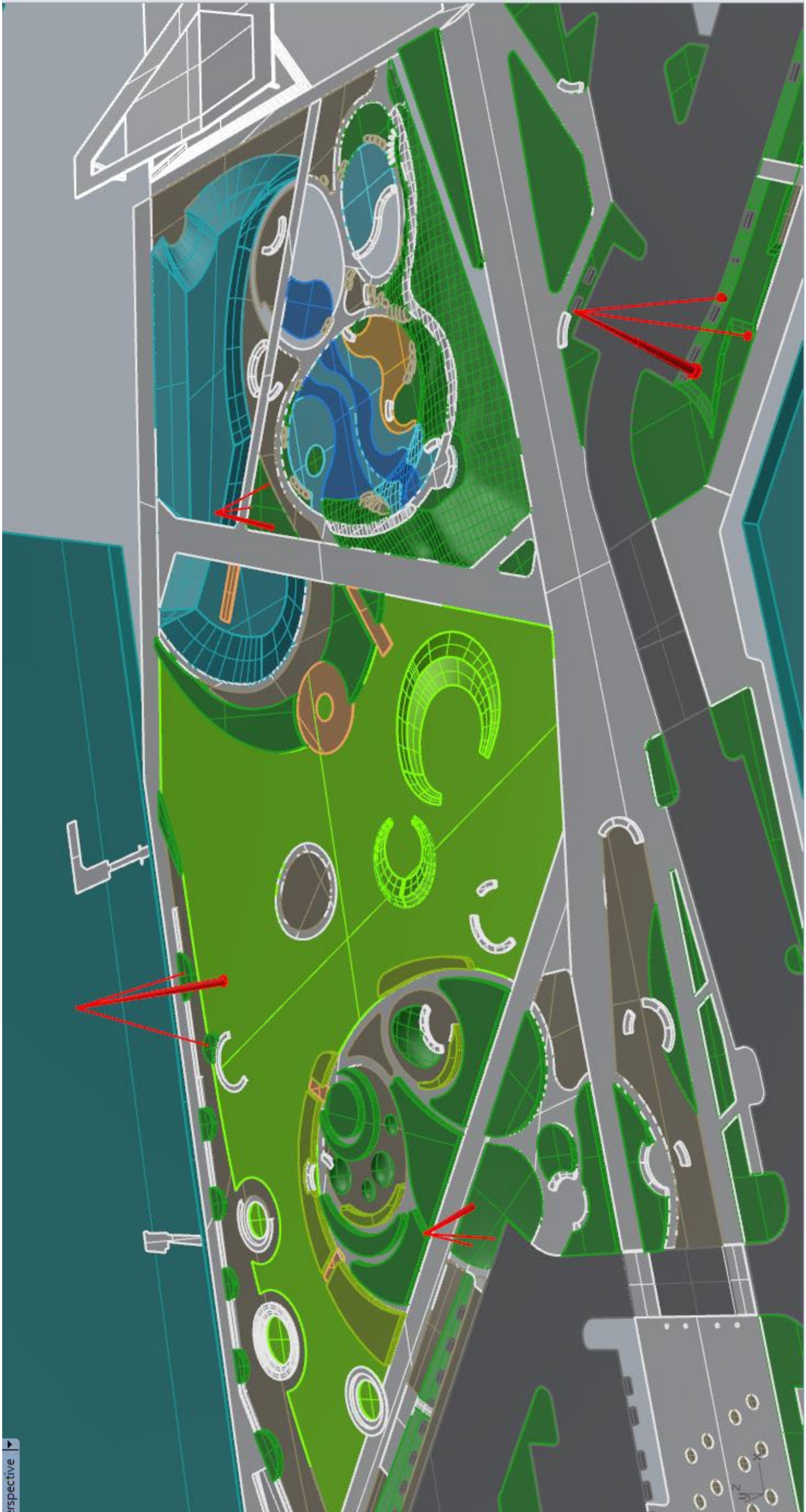

perspective



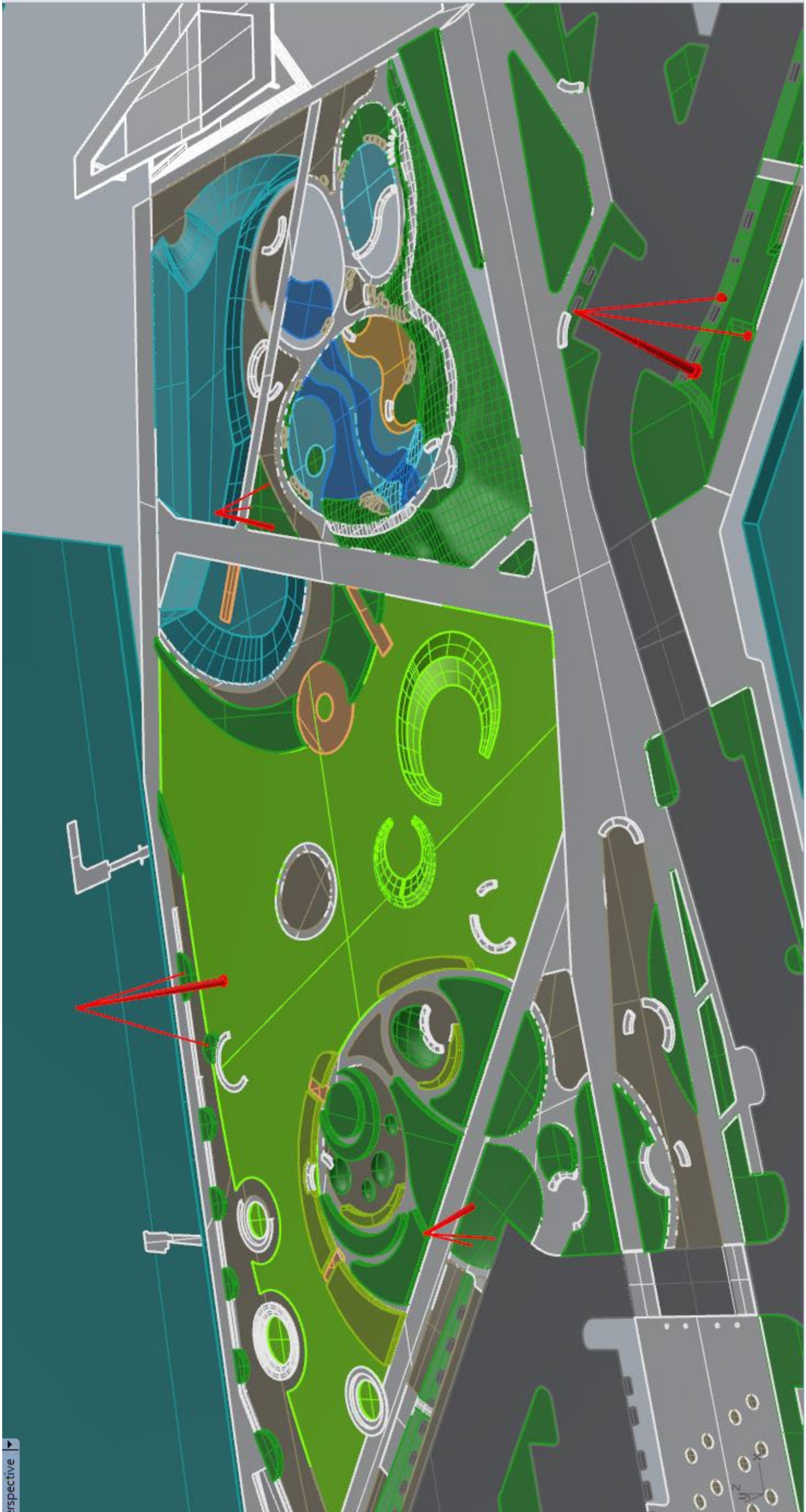

erspective



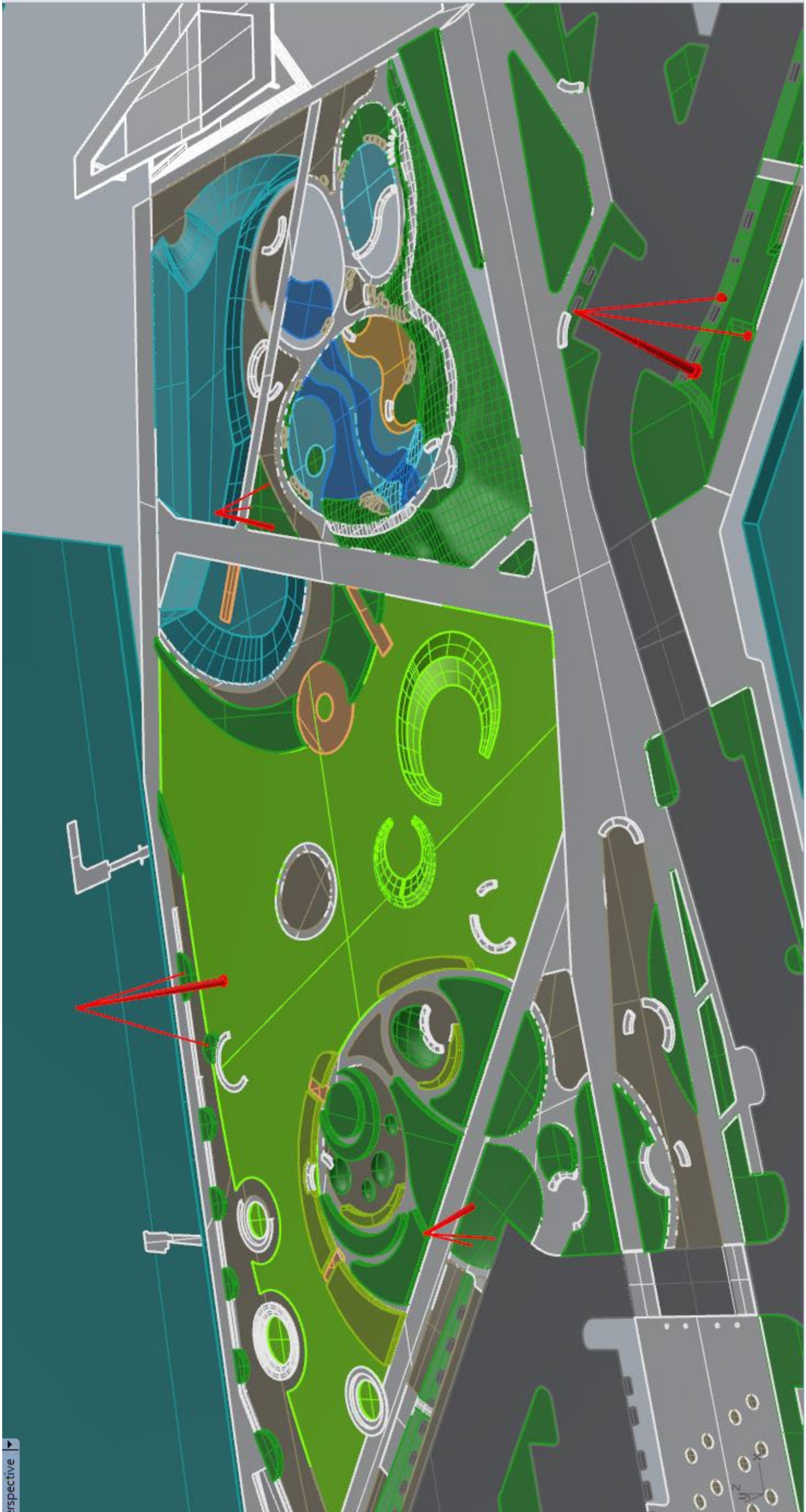

WESTERN PYLON

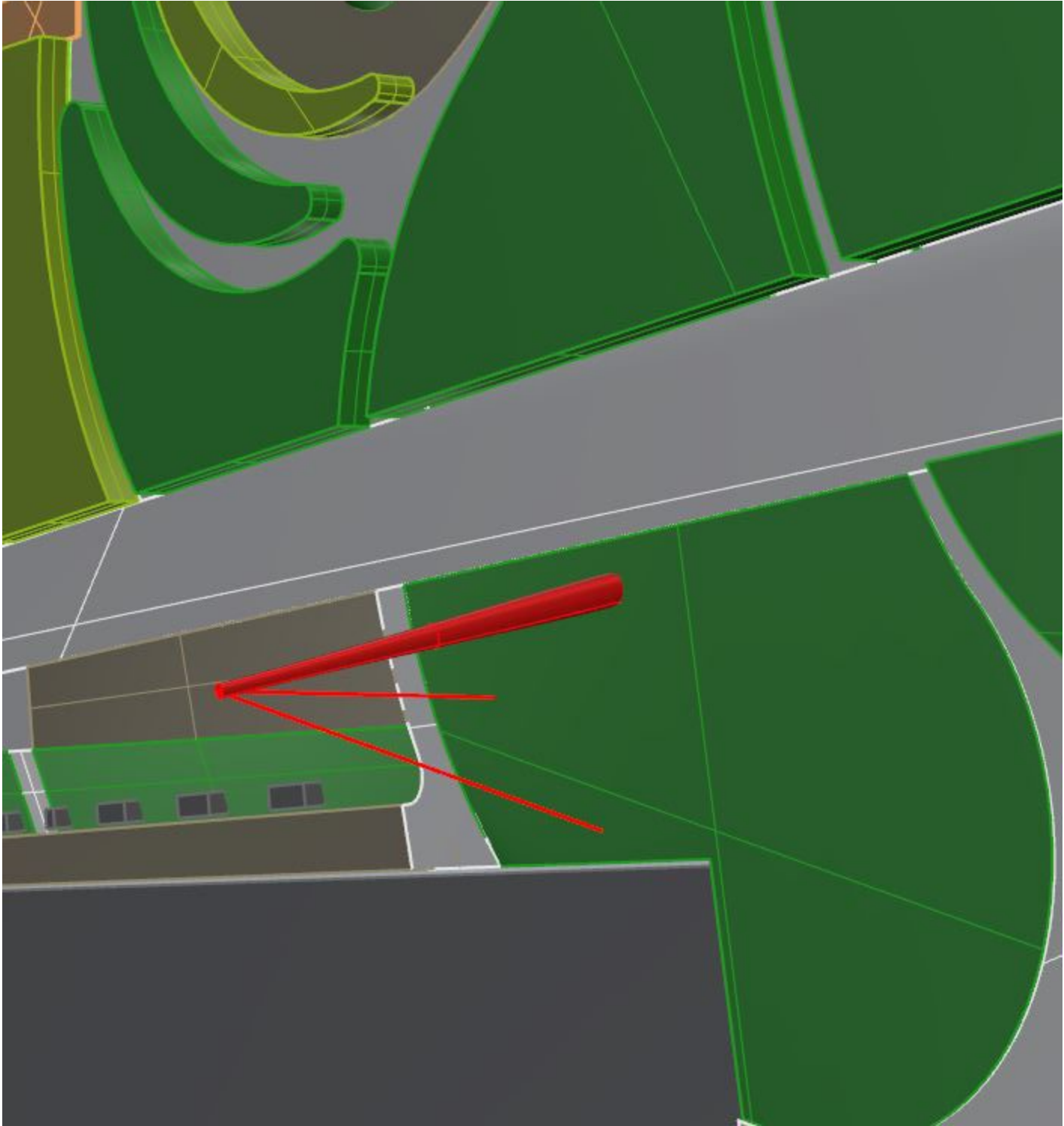



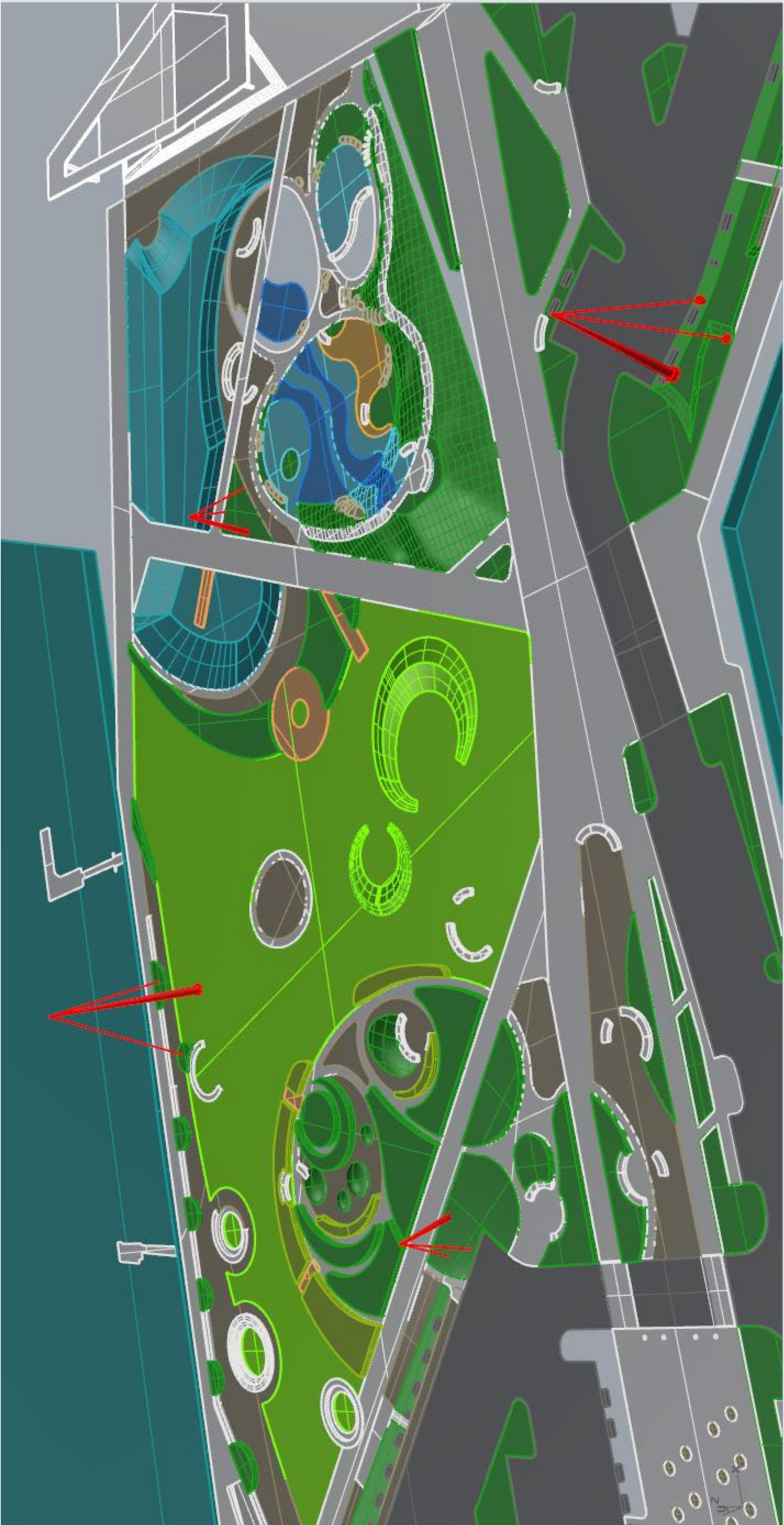





NORTHERN PYLON





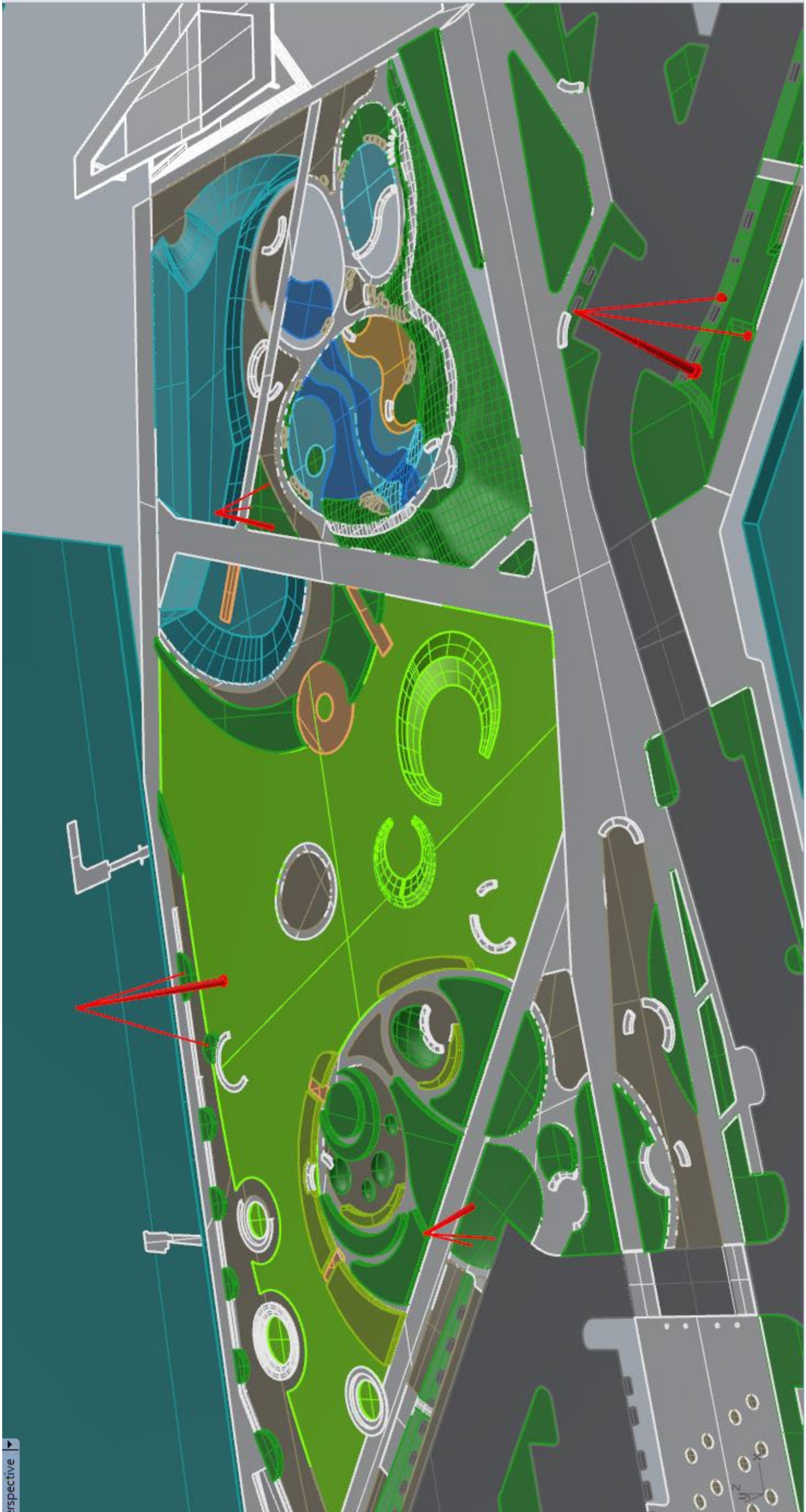

erspective ▾



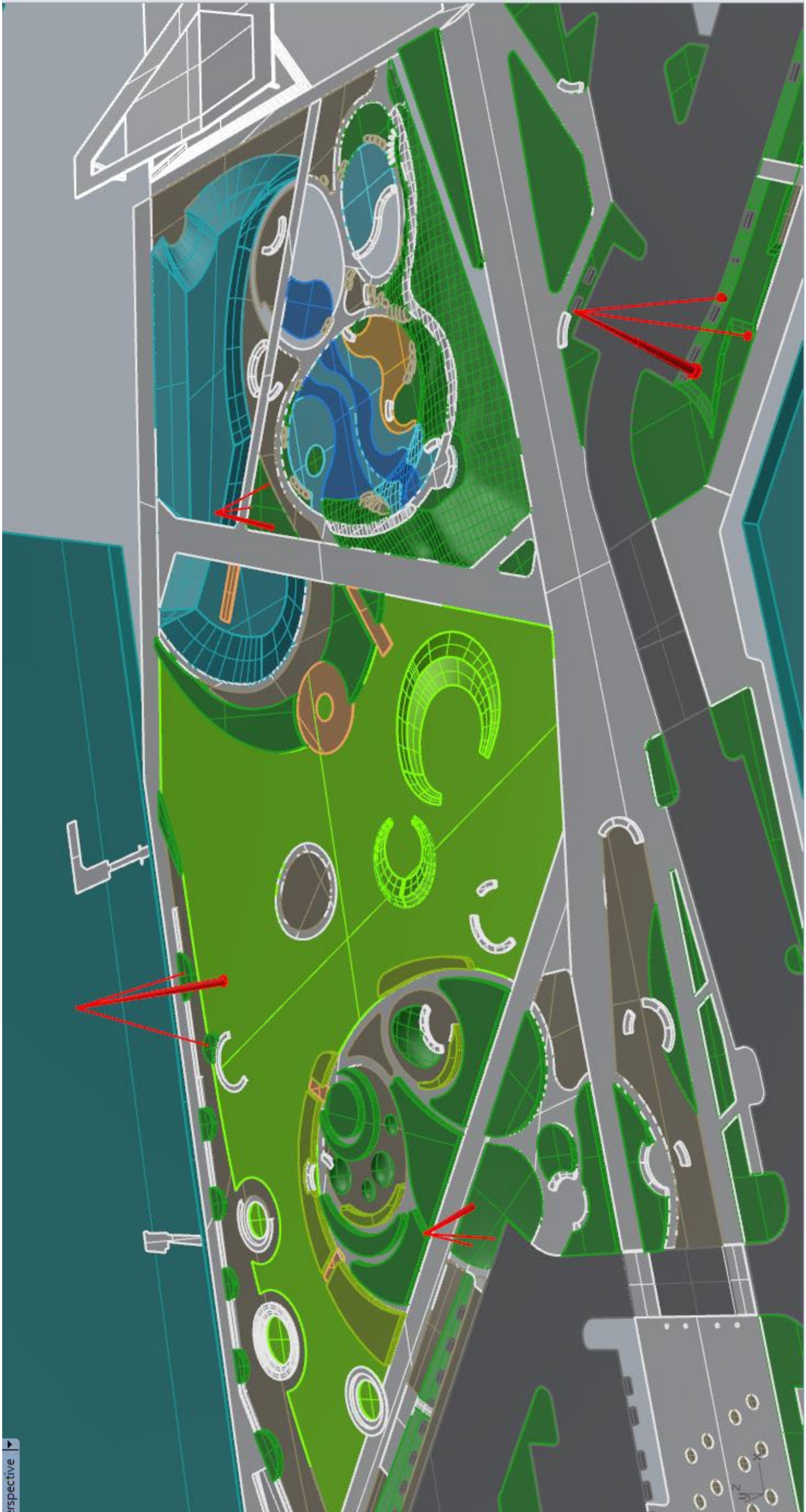

perspective

## 5 Project Schedule



The New St. Petersburg Pier			Master Schedule												Data Date: 06-Feb-19    Date Printed: 13-Feb-19															
Activity ID	Activity Name	Original Duration	Remaining Duration	Start	Finish																									
						Dec	Jan	Feb	Mar	Apr	May	Jun	Jul	Aug	Sep	Oct	Nov	Dec	Jan	Feb	Mar	Apr	May	Jun	Jul	Aug	Sep	Oct	Nov	Dec
The New St. Petersburg Pier_CURRENT																														
Added Scope (Under Review)																														
Pier Approach																														
Artwork																														
Echelman (Net Sculpture)																														
Pre- Construction																														
SK2069	Lease Agreement																													
SK2070	City Council Approval																													
SK2071	100% CD (Bulletin 2)																													
SK2940	Foundations Early Release Package																													
SK2941	ERP - Skanksa CD Estimate																													
SK2073	Skanksa CD Estimate																													
SK3053	JEI / ARUP Echelman 100% CDs																													
SK3104	Net & Structural Cabling Design																													
SK2072	100% CD Permitting																													
SK2630	Procurement FAB & Delivery ( By Echelman)																													
SK2975	City To Confirm Private / Public Funding To Support Infrastructure																													
SK2074	City Council Approval																													
SK2075	Notice To Proceed																													
Procurement																														
Concrete (Deep Foundations)																														
SK2631	Award Contracts																													
SK2632	Prepare Submittals - Concrete																													
SK2633	Review & Approve Submittals by Architect																													
SK2634	FAB & Delivery																													
Steel																														
SK2635	Award Contracts																													
SK2636	Prepare Submittals - Concrete																													
SK2637	Review & Approve Submittals by Architect																													
SK2638	FAB & Delivery																													
Construction																														
SK2639	Install Deep Foundations																													
SK2641	Install Anchor Bolts & Inspect																													
SK2640	Install Pylons																													
SK2643	Prep Net & Cables For Sculpture																													
SK2644	Hoisting Sculpture & Securing																													

# 6

## Appendix - A

- 5.04 L Janet Echelman Arup Lighting Report 02 (Pages 39-48)
- 1212 DMX/RDM Isolated Splitter (Page 49)
- 12-14-2018 St Pete Pier Approach 100% Bulletin #2 Narrative (Pages 50-58)
- 12-14-2018 Bulletin 2 Construction Drawings (Pages 59-118)
- 7180L1054 Mosaic Touchscreen Datasheet Rev A (Pages 119-120)
- 129300 SITE FURNISHINGS Bulletin 2 Specifications (Pages 121-125)
- 265500 SPECIAL PURPOSE LIGHTING Bulletin 2 Specifications (Pages 126-130)
- Echelman St. Pete Permit Set Construction Structural Drawings 1-11-2019 by ARUP (Pages 131-140)
- Echelman St. Pete Permit Construction Specifications 1-11-2019 by ARUP (Pages 141-206)
- HEARTLAND BOX – Exterior Lighting Control Enclosure (Pages 207-212)
- Mosaic MSC1 Specification – Lighting Controller Specification 06-2015 (Pages 213-216)
- Unison Mosaic Show Controller Data Sheets By ETC (Pages 217-218)
- ST.PETERSBURG PIER SCULPTURE RISER REVA-Layout1 (Page 219)
- ARUP E-mail Dated 2-12-19 and Associated Backup Materials – ARUP Confirming Engineering and Manufacturer Coordination For Light Pole Modifications (Pages 220-225)
- Authorization Request AR #24 – Associated Previously Contracted Work With Bulletin 2 (Pages 226-230)



**Skanska USA Building Inc.**  
[usa.skanska.com](http://usa.skanska.com)

4030 Boy Scout Boulevard  
Suite 200  
Tampa, FL 33607  
813.282.7100